





Building a Framework for Success

Door Components, Inc. was founded in 1981 by Bob Briggs Sr. to fill a void in the hollow metal industry. At the time, there were few custom manufacturers who could make special doors and frames on a very short lead time.

More than 30 years later, we have built our reputation as the service company that manufactures hollow metal doors and frames. Our expanded manufacturing plant is equipped with the most modern and advanced machinery available. With knowledgeable and experienced personnel continually striving for innovation and advancement, we are paving the way for the future of the hollow metal door industry.



WHAT WE DO

At DCI Hollow Metal we manufacture custom doors and frames. Our philosophy is to provide you with the product you need when you need it. Period.

TABLE OF CONTENTS

Metal Doors

Custom Honeycomb Core Doors	pg. 4
Custom Polystyrene Core Doors	pg. 4
Steel Stiffened Core Doors	pg. 5
Temperature Rise Core Doors	pg. 5
Lead Lined (radiation shielding) Doors	pg. 6
Rail and Stile Doors	pg. 6
Sound Transmission Control (STC) Doors	pg. 7
Bullet Resistant Doors	pg. 7

Metal Doors

Tornado Door	pg. 8
Integral Louver	pg. 8
Fire Rated	pg. 9
Integral Lite	pg. 9

Metal Door Systems

Dutch Doors	pg. 10
Double Egress	pg. 10

Frame Profiles

pg. 11

Frame Options

Hospital Stop	pg. 12
Bullet Resistant	pg. 13
Lead Lined	pg. 13
Side Lite	pg. 13
Fire Rated	pg. 13

Frames

KD Drywall	pg. 14
Double Egress	pg. 14
Pocket Slides	pg. 15
Masonry	pg. 15
Sound Transmission Control (STC) Window	pg. 16
	pg. 17

Resources

pg. 19

INDUSTRY AFFILIATIONS



WHAT SETS US APART

Door Components is proud to be a manufacturer of custom hollow metal doors and frames on some of the most prestigious building projects in the Western United States and overseas. Our on-time delivery supports the growing demand for fast track construction; Door Components is staffed to meet our schedule commitments.

As a member of SDI (Steel Door Institute), our quality assurance meets or exceeds that required by SDI 100, ANSI A250.8 and HMMA 860/861 (NAAMM). Our fire rated products are tested and listed in strict compliance with provisions of NFPA 80, NFPA 252, ASTM E2074, UBC 7-2-1997 and UL 10B & 10C.



COMMERCIAL



CORPORATE



EDUCATION



HOSPITALITY



RELIGIOUS



MEDICAL



GOVERNMENT

LEED AND SUSTAINABILITY

The benchmark for sustainable design in the United States is the Leadership in Energy and Environmental Design (LEED®) rating system developed by the U.S. Green Building Council (USGBC). Through this system, buildings become LEED certified by earning credits from the following categories: sustainable sites, water efficiency, energy and atmosphere, materials and resources, and indoor environmental quality.

Based on calculations of the American Iron and Steel Institute:

DCI Hollow Metal products have a Steel Recycled Content Value = 37.1%

LEED credits applicable to the hollow metal products of Door Components are as follows:

Materials & Resources LEED NC v3 Credit 4: Recycled Content

- Credit 4.1 (1 point)
- Credit 4.2 (1 point in addition to MR 4.1)

Materials & Resources LEED NC v3 Credit 5: Regional Materials

- Credit 5.1 (1 point)
- Credit 5.2 (1 point in addition to MR 5.1)

Let us help as you strive to design green buildings that are safe, sustainable and aesthetically pleasing.

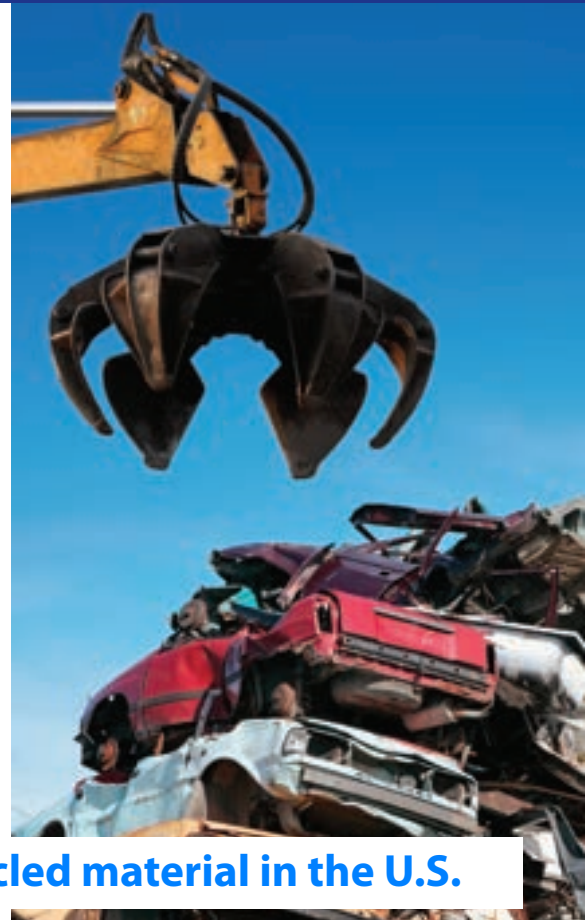

Steel is the most recycled material in the U.S.

CUSTOM HONEYCOMB CORE DOORS



FEATURES

- 1 ¾" standard; also available in 1 ⅝"
- Any manufacturer's hinge locations
- 18-gauge A40 galvanized steel standard
- Continuously welded vertical edges (seamless) standard
- Rust inhibitive prime coat ANSI/SDI 250.10

MATERIAL OPTIONS

- 16-gauge and 14-gauge
- G90 galvanized steel
- Resin impregnated honeycomb

FEATURE OPTIONS

- Up to 3 hour fire label
- Integral lite option
- Integral louver option
- Flush top cap
- Any manufacturer's Deadlock prep, Panic prep, and Mortise sectional trim
- Flat bar astragal (pairs)

HARDWARE REINFORCEMENTS

- ⅜" for hinges
- 12-gauge for locks – standard
- 14-gauge for closers – standard
- Heavier gauge reinforcements available



10 MILLION CYCLES | Successfully completed in independent test

CUSTOM POLYSTYRENE CORE DOORS



FEATURES

- 1 ¾" standard; also available in 1 ⅝"
- Any manufacturer's hinge locations
- 18-gauge A40 galvanized steel standard
- Continuously welded vertical edges (seamless) standard
- Rust inhibitive prime coat ANSI/SDI 250.10

MATERIAL OPTIONS

- 16-gauge and 14-gauge
- G90 galvanized steel

FEATURE OPTIONS

- Up to 3 hour fire label
- Integral lite option
- Integral louver option
- Flush top cap
- Any manufacturer's Deadlock prep, Panic prep, and Mortise sectional trim
- Flat bar astragal (pairs)

HARDWARE REINFORCEMENTS

- ⅜" for hinges
- 12-gauge for locks standard
- 14-gauge for closers standard
- Heavier gauge reinforcements available



2 MILLION CYCLES | Successfully completed in independent test

STEEL STIFFENED DOORS



FEATURES

- 1 3/4" standard; other thicknesses available
- Any manufacturer's hinge locations
- 18-gauge steel A40 galvanized standard
- 20-gauge stiffeners spot-welded at 6" on center with fiberglass insulation
- Continuously welded vertical edges (seamless) standard
- Rust inhibitive prime coat ANSI/SDI 250.10

MATERIAL OPTIONS

- 16-gauge, 14-gauge, and 12-gauge,
- G90 galvanized steel
- 18-gauge stiffeners spot-welded

FEATURE OPTIONS

- Up to 3 hour fire label
- Integral lite option
- Integral louver option
- Flush top cap
- Any manufacturer's Deadlock prep, Panic prep, and Mortise sectional trim
- Flat bar astragal (pairs)

HARDWARE REINFORCEMENTS

- 3/16" for hinges
- 12-gauge for locks standard
- 14-gauge for closers standard
- Heavier gauge reinforcements available



4 MILLION CYCLES | Successfully completed in independent test

TEMPERATURE RISE DOORS



FEATURES

- 1 3/4" standard
- Any manufacturer's hinge locations
- 18-gauge steel A40 galvanized standard
- 18-gauge top and bottom channels spot welded to face sheets
- Continuously welded vertical edges (seamless) standard (open seam available)
- 60 – 180 min. labels available for 450°, and 250° temp rise at 30 min.
- Rust inhibitive prime coat ANSI/SDI 250.10

MATERIAL OPTIONS

- 16-gauge and 14-gauge steel
- G90 galvanized steel

FEATURE OPTIONS

- Integral lite option, up to 100 sq. inches (only for 60 and 90 min. ratings)
- Flush top cap
- Any manufacturer's Deadlock prep, Panic prep, and Mortise sectional trim
- Flat bar astragal (pairs)

HARDWARE REINFORCEMENTS

- 3/16" for hinges
- 12-gauge for locks standard
- 14-gauge for closers standard
- Heavier gauge reinforcements available

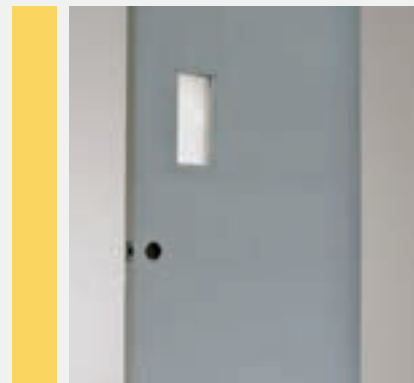

LEAD LINED (RADIATION SHIELDING) DOORS



FEATURES

- 1 3/4" standard; other thicknesses available
- Medical shielding uses
- Any manufacturer's hinge locations
- 18-gauge galvanized steel standard
- 18-gauge top and bottom channels spot welded to face sheets
- Continuously welded vertical edges (seamless) standard
- Rust inhibitive prime coat ANSI/SDI A250.10
- 99.9% pure lead meeting federal specifications QQ-L-201F Grade C and ASTM B749

MATERIAL OPTIONS

- 16-gauge and 14-gauge steel
- DCI Hollow Metal does not sell lead glass. Glass is procured and installed by others.

FEATURE OPTIONS

- Flush top cap
- Any manufacturer's Deadlock prep, Panic prep, and Mortise sectional trim

HARDWARE REINFORCEMENTS

- 3/16" for hinges
- 12-gauge for locks standard
- 14-gauge for closers standard
- Heavier gauge reinforcements available

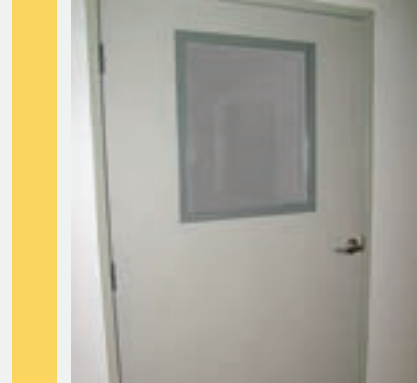

RAIL AND STILE DOORS



FEATURES

- Vision lite standard
- Any manufacturer's hinge locations
- 1 3/4" standard
- 18-gauge top and bottom inverted channels spot welded to face sheets
- Continuously welded vertical edges (seamless) standard
- 18-gauge galvanized steel standard
- Rust inhibitive prime coat ANSI/SDI 250.10

MATERIAL OPTIONS

- 16-gauge and 14-gauge steel
- G90 galvanized steel

FEATURE OPTIONS

- Up to 90 minute fire label
- Integral louver option
- Flush top cap
- Any manufacturer's Deadlock prep, Panic prep, and Mortise sectional trim
- Flat bar astragal (pairs)

HARDWARE REINFORCEMENTS

- 3/16" for hinges
- 12-gauge for locks standard
- 14-gauge for closers standard
- Heavier gauge reinforcements available

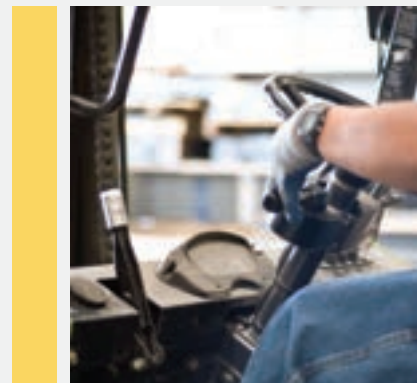

SOUND TRANSMISSION CONTROL (STC) DOORS

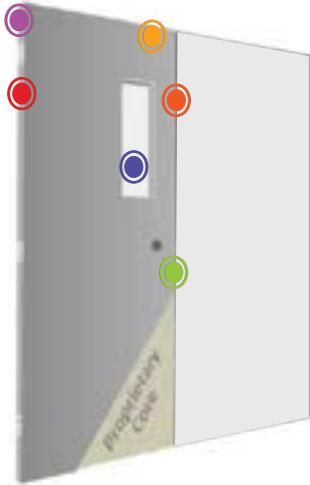

FEATURES

- Up to and including STC 48 for pairs of doors; includes factory-supplied astragal
- STC core is Door Components patented design
- All STC ratings available for single doors up to and including STC 54
- 1 3/4" doors (light weight for STC doors)
- Any manufacturer's hinge locations
- Continuously welded vertical edges (seamless) standard
- Uses 4 1/2" .180 heavyweight hinge (not supplied)
- No cam lift hinge required
- All required seals and a threshold are included
- Galvannealed steel standard
- Single door vision lites available up to and including STC 48
- Rust inhibitive prime coat ANSI/SDI A250.10
- Tested in accordance with ASTM E90-09
- Frame must be grout filled (by others)
- Acoustic frames available

MATERIAL OPTIONS

- A40, A60, and G90

FEATURE OPTIONS

- Up to 90 minute fire label
- Integral lite option
- Flush top cap
- Any manufacturer's Deadlock prep, Panic prep, and Mortise sectional trim
- Astragal (for pairs)

HARDWARE REINFORCEMENTS

- 3/16" for hinges
- 12-gauge for locks standard
- 14-gauge for closers standard
- Heavier gauge reinforcements available

STC Transmission Class Capabilities

STC Range	Description
STC 50 - STC 54	Very loud sounds are faintly heard
STC 40 - STC 49	Loud speech is barely audible
STC 35 - STC 39	Loud speech is audible but words hard to distinguish
STC 30 - STC 34	Loud speech can be distinguished; normal speech barely heard or inaudible

BULLET RESISTANT DOORS



FEATURES

- Tested in accordance with UL 752 level 1 through 8 for ballistic products
- 1 3/4" standard
- Any manufacturer's hinge locations
- 16-gauge A40 galvannealed steel standard
- Minimum 16-gauge steel faces
- Continuously welded vertical edges (seamless) standard
- Rust inhibitive prime coat ANSI/SDI 250.10
- Bullet resistant frames available

MATERIAL OPTIONS

- 16-gauge steels
- G90 galvanized steel
- Stainless steel, available in 304 or 316 alloys

FEATURE OPTIONS

- Vision lite frame
- Flush top cap
- Any manufacturer's Deadlock prep, Panic prep, and Mortise sectional trim

HARDWARE REINFORCEMENTS

- 3/16" for hinges
- 12-gauge for locks standard
- 14-gauge for closers standard
- Heavier gauge reinforcements available

Threat Level

LEVEL	CALIBER	BULLET	SHOTS
1	9mm (124g) FMJ		3
2	.357 Magnum (158g) SP		3
3	.44 Magnum (244g) SP		3
4	.30 Caliber Rifle (180g) SP		1
5	7.62mm Rifle (150g) FMJ		1
6	9mm Multi (124g) FMJ		5
7	5.56mm Rifle (55g)		5
8	7.62 Multi Rifle (150g) FMJ		5
8 (AP)	30-60 Rifle (166g) AP		5

METAL DOORS

TORNADO RESISTANT - FEMA 361 | ICC-500 Compliant

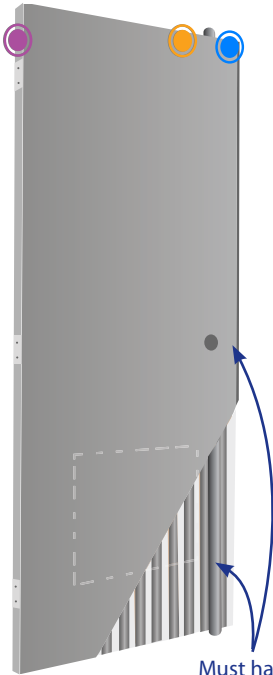

FEATURES

- 1 3/4" standard thickness
- Any manufacturer's butt hinge
- 14-gauge steel A40 galvanized standard
- 12-gauge stiffeners spot-welded at 4" on center with fiberglass insulation
- Continuously welded vertical edges (seamless) standard
- Rust inhibitive prime coat ANSI/SDI 250.10
- Available up to 4'x8' singles/8'x8' pairs
- Singles available in-swing or out-swing

MATERIAL OPTIONS

- G90 galvanized steel

FEATURE OPTIONS

- Flush top cap
- Must use with Securitech hardware

Must have multi-point latching by Securitech (not provided by Door Components).
May be surface or concealed in door.

INTEGRAL LOUVER



FEATURES

- Door with louvers installed as a completed unit

DOOR OPTIONS

- Honeycomb core doors (custom)
- Polystyrene core doors (custom)
- Dutch doors
- Rail and stile doors

FEATURE OPTIONS

- Optional insect screen

FIRE RATED



FEATURES

- Up to 3 hour fire label
- Includes some doors with lites
- Wire glass, Pilkington Glass w/ Pemko fireglaze (or equal) and Firelite (or equal) glass, supplied by others
- Fire rated frames available

DOOR OPTIONS FOR FIRE RATING

- Honeycomb core doors
- Polystyrene core doors
- Dutch doors
- Rail and stile doors
- Sound Transmission Control (STC)
- Steel stiffened core doors
- Temperature rise core doors

HARDWARE REINFORCEMENTS

- Integral lite
- Flush top cap
- Flat bar astragal (pairs) optional



INTEGRAL LITE



FEATURES

- Vision lite cutout and frame without factory-supplied glass is standard
- Door with glass installed as a completed unit (option)
- Most common glass types and sizes in stock for rapid installation

FEATURE OPTIONS

- Honeycomb core doors
- Polystyrene core doors
- Dutch doors
- Rail and stile doors
- Steel stiffened core doors
- Temperature rise core doors

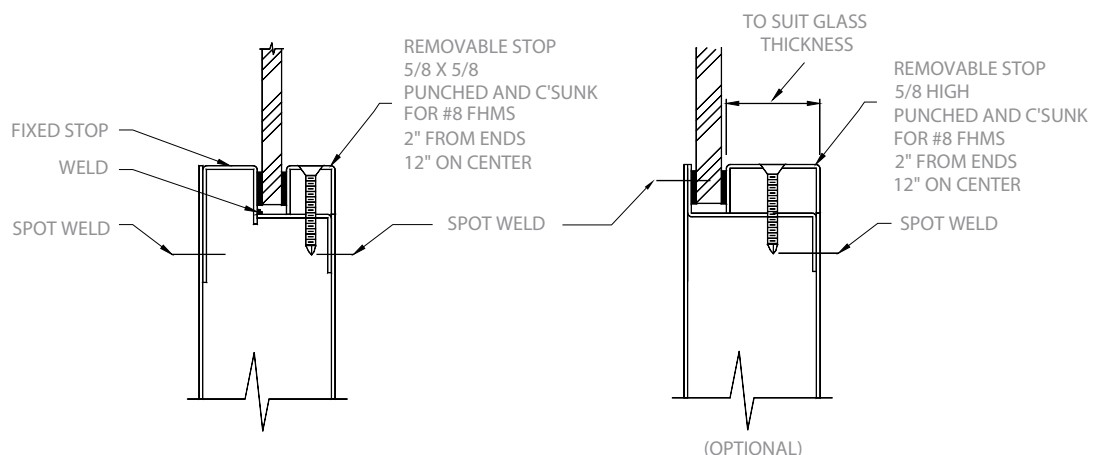

- 1) 16 GA GLASS STOP (OTHER GAUGES AVAILABLE)
- 2) REMOVABLE STOP IS PUNCHED AND COUNTERSUNK 2\"

METAL DOOR SYSTEMS

DUTCH DOORS



FEATURES

- 1 3/4" standard; other thicknesses available
- Any manufacturer's hinge locations 18-gauge A40 galvanized steel standard
- Continuously welded vertical edges (seamless) standard
- Rust inhibitive prime coat ANSI/SDI 250.10
- Honeycomb core standard

MATERIAL OPTIONS

- 16-gauge and 14-gauge
- G90 galvanized steel
- Polystyrene core

FEATURE OPTIONS

- Single and double-sided shelf
- Up to 3 hour fire label
- Integral lite option
- Flush top cap
- Any manufacturer's Deadlock prep, Panic prep, and Mortise sectional trim
- Flat bar astragal

HARDWARE REINFORCEMENTS

- 3/16" for hinges
- 12-gauge for locks standard
- 14-gauge for closers standard
- Heavier gauge reinforcements available



DOUBLE EGRESS DOORS

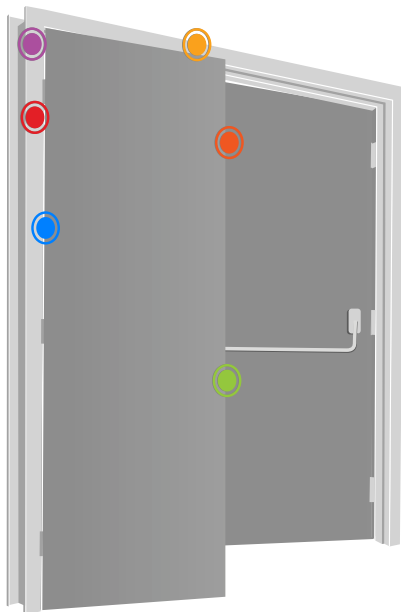

FEATURES

- 1 3/4" standard
- Any manufacturer's hinge locations
- 18-gauge A40 galvanized steel standard
- Continuously welded vertical edges (seamless) standard
- Rust inhibitive prime coat ANSI/SDI 250.10

MATERIAL OPTIONS

- 16-gauge, 14-gauge and 12-gauge steel
- G90 galvanized steel
- Resin impregnated honeycomb

FEATURE OPTIONS

- Up to 3 hour fire label
- Flush top cap
- Any manufacturer's Deadlock prep, Panic prep, and Mortise sectional trim
- Flat bar astragal (pairs)

HARDWARE REINFORCEMENTS

- 3/16" for hinges
- 12-gauge for locks standard
- 14-gauge for closers standard
- Heavier gauge reinforcements available



CUSTOM DOOR FRAME PROFILES

All frames are custom manufactured to your order. Here are some examples of frames that we can build.

Available in 12-gauge, 14-gauge, and 16-gauge A60 Hot Dipped Galvanized Steel ASTM A653.

Face profile may be combined with any backbend. Backbends can be any combination on the same frame to meet your needs.

G90 Galvanized Steel available.

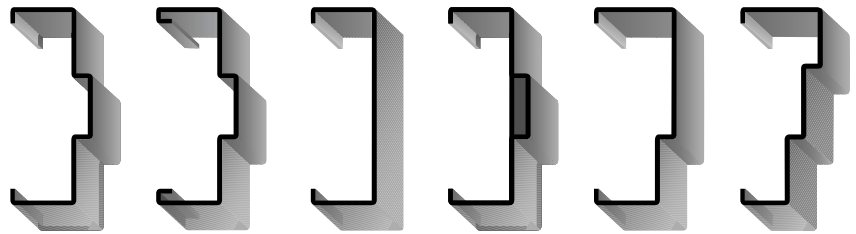

F1

F3

F9

F16

F2

F15

WALL ANCHORS

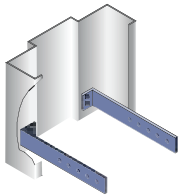

A1
Standard Strap
Anchor

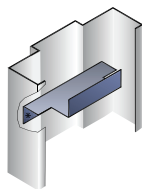

A2
Flush Metal Stud
Anchor

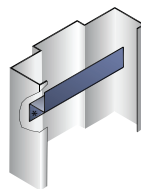

A3
Recessed Metal
Stud Anchor

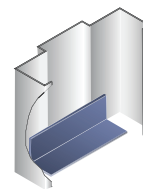

A4
Standard Base
Anchor

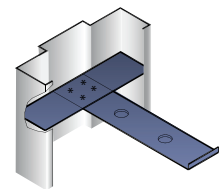

A5
Masonry Steel
Anchor

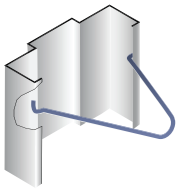

A6
Alternate Masonry
Steel Anchor

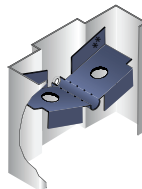

A7B
Punch & Dimple
"Butterfly" Anchor

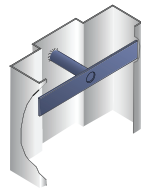

A7P
Punch & Dimple
Alternate Masonry Anchor

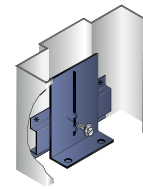

A8
Adjustable Base
Anchor 5/32

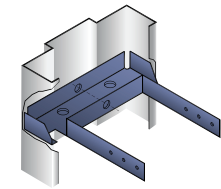

A9
Twist In Universal
Anchor

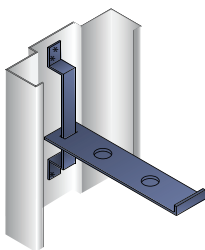

A11
Adjustable Masonry
Anchor

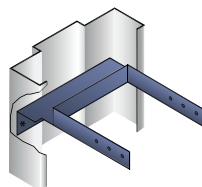

A9W
Welded In Universal
Anchor

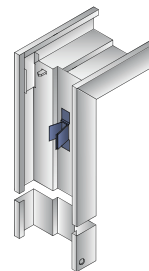

A10
KDDW Compressed
Anchor

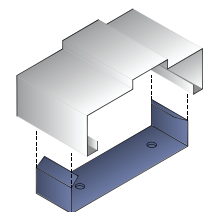

A12
Floor Anchor

FRAME OPTIONS

DCI Hollow Metal is a hollow metal door and frame manufacturer specializing in the rapid shipment of custom products. All of our doors and frames are manufactured to our clients' specifications.

While our specialty is manufacturing custom frames, we also make KD drywall and masonry frames to your specifications.

Our standard frame product is 16-gauge A40 galvanized steel; we offer other material options including A60 galvanized and G90 galvanized. See the individual frame pages for details.

As a member of the Steel Door Institute, you can be assured that all Door Components products meet the highest standards in the hollow metal industry.

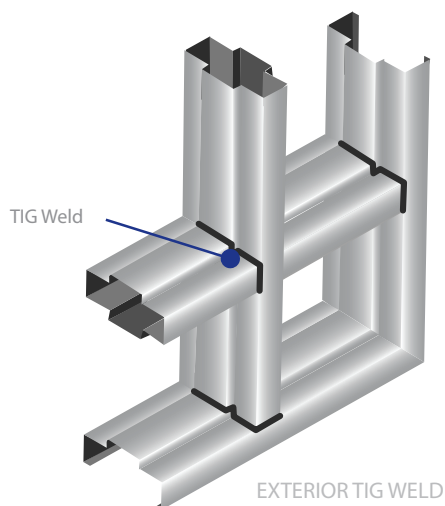
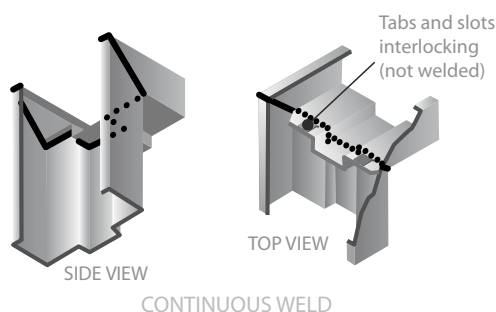
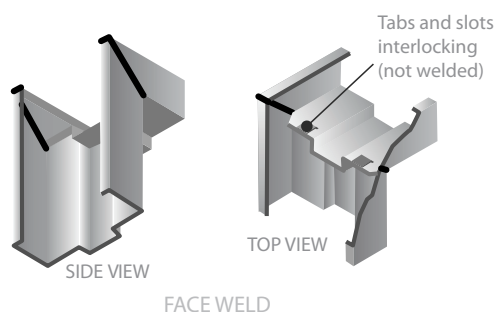

Take advantage of the full DCI Hollow Metal treatment. Let us provide that finishing touch to your project with our custom products:

- Face welds
- Continuous welds (additional charge)
- Quality welding by factory-trained technicians
- Professional grinding and baked-on primer paint finish
- No mismatched or missing components
- No jobsite sorting of stick components
- No additional time loss; same delivery time welded or KD
- Picked up at our dock or delivered to your shop or job, ready to install
- Strict adherence to welding standards; OSHPOD-quality welds.
- No need for certified welder at jobsite
- No certified payroll requirement, for a factory-complete product

Hospital Stop

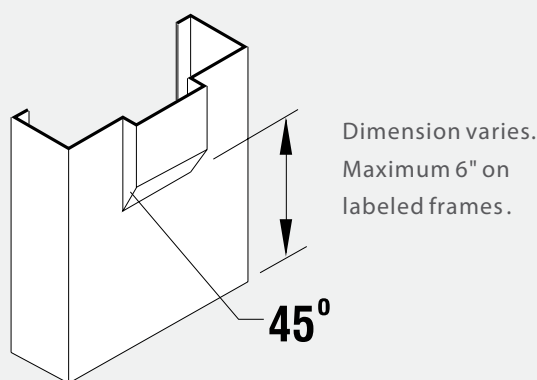

LEAD LINED (RADIATION SHIELD)

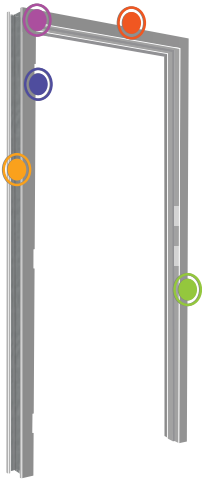

FEATURES

- Radiation shielding capabilities
- Medical shielding uses
- Face weld
- 16-gauge A40 galvanized steel standard
- 7-gauge hinge reinforcements standard
- 12-gauge closer reinforcements standard
- Rust-inhibitive prime coat ANSI/SDI 250.10
- Any manufacturer's hinge locations
- Any manufacturer's strike prep location
- Anchors to meet any wall construction
- Any width and height
- Any jamb depth
- Lead Lined doors available
- 99.9% pure lead meeting federal specifications QQ-L-201F, Grade C and ASTM B749

MATERIAL OPTIONS

- 14-gauge and 12-gauge steel

FEATURE OPTIONS

- Continuous weld

HARDWARE REINFORCEMENTS

- Optional prep to accept all manufacturers' hardware requirements

BULLET RESISTANT

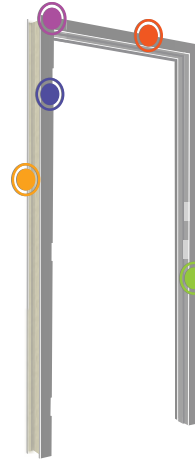

FEATURES

- Tested in accordance with UL 752 level 1 through 8 for ballistic products
- Face weld
- 16-gauge A40 galvanized steel standard
- 7-gauge hinge reinforcements standard
- 12-gauge closer reinforcements standard
- Rust-inhibitive prime coat ANSI/SDI 250.10
- Any manufacturer's hinge locations
- Any manufacturer's strike prep location
- Anchors to meet any wall construction
- Any width and height
- Any jamb depth
- Bullet resistant doors available

MATERIAL OPTIONS

- 14-gauge and 12-gauge steel

FEATURE OPTIONS

- Continuous weld

HARDWARE REINFORCEMENTS

- Optional prep to accept all manufacturers' hardware requirements

SIDE LITE

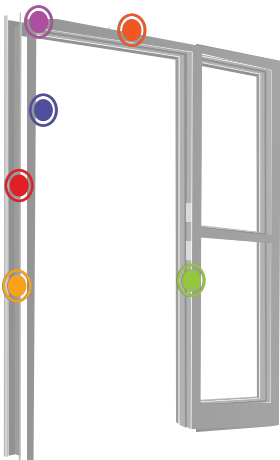

FEATURES

- Face weld
- 16-gauge A40 galvanized steel standard
- 7-gauge hinge reinforcements standard
- 12-gauge closer reinforcements standard
- Rust-inhibitive prime coat ANSI/SDI 250.10
- Any manufacturer's hinge locations
- Any manufacturer's strike prep location
- Anchors to meet any wall construction
- Any width and height
- Any jamb depth
- Glass stop 3/8" width standard - custom sizes available
- Glazing not included

MATERIAL OPTIONS

- 14-gauge and 12-gauge steel

FEATURE OPTIONS

- Up to 90 minute fire label

HARDWARE REINFORCEMENTS

- Optional prep to accept all manufacturers' hardware requirements

FIRE RATED

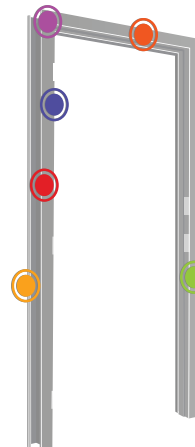

FEATURES

- Face weld
- 16-gauge A40 galvanized steel standard
- 7-gauge hinge reinforcements standard
- 12-gauge closer reinforcements standard
- Rust-inhibitive prime coat ANSI/SDI 250.10
- Any manufacturer's hinge locations
- Any manufacturer's strike prep location
- Anchors to meet any wall construction
- Any width and height
- Any jamb depth

MATERIAL OPTIONS

- 14-gauge and 12-gauge steel

FEATURE OPTIONS

- Deadlock strike
- Continuous weld
- Up to 3 hour fire label

HARDWARE REINFORCEMENTS

- Optional prep to accept all manufacturers' hardware requirements

KD DRYWALL FRAMES

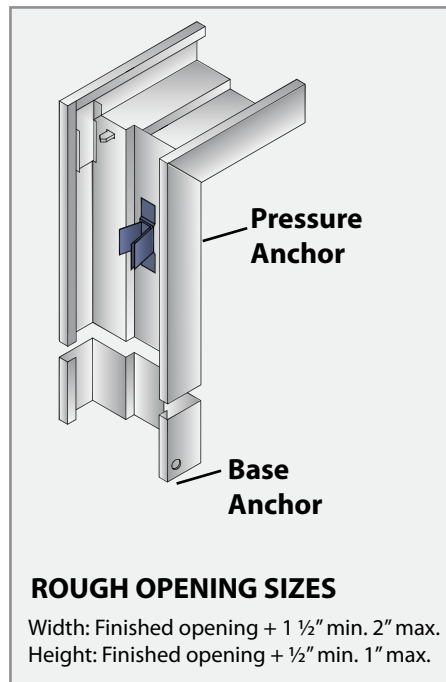
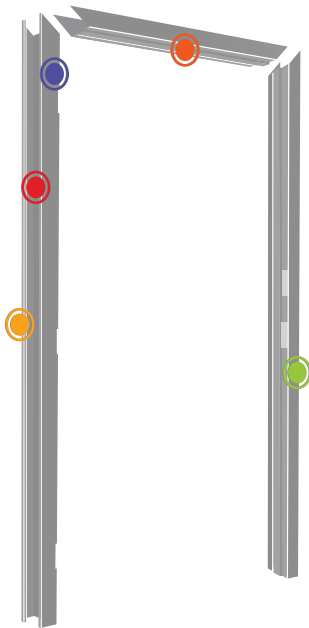

FEATURES

- 16-gauge A40 galvanized steel standard
- 7-gauge hinge reinforcements standard
- 12-gauge closer reinforcements standard
- Rust-inhibitive prime coat ANSI/SDI 250.10
- ● Any manufacturer's hinge locations
- ● Any manufacturer's strike prep location
- ● KD Drywall Anchor
- Any width and height
- Any jamb depth

MATERIAL OPTIONS

- 14-gauge steel

FEATURE OPTIONS

- ● Up to 90 minute fire label
- Hospital stop

HARDWARE REINFORCEMENTS

- ● Optional prep to accept all manufacturers' hardware requirements

DOUBLE EGRESS FRAMES

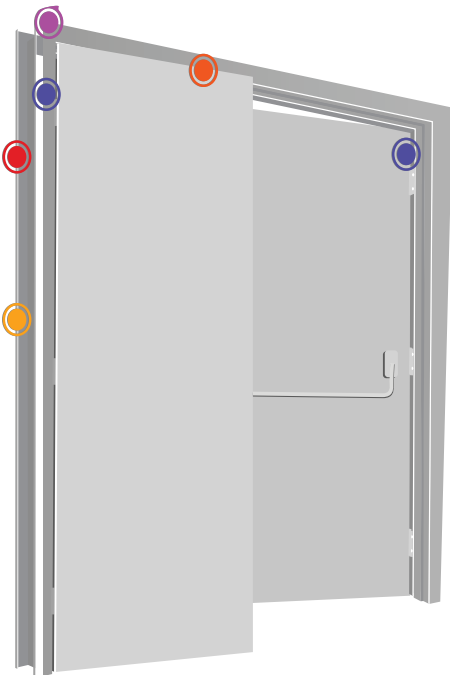

FEATURES

- ● Face weld
- 16-gauge A40 galvanized steel standard
- 7-gauge hinge reinforcements standard
- 12-gauge closer reinforcements standard
- Rust-inhibitive prime coat ANSI/SDI 250.10
- ● Any manufacturer's hinge locations
- ● Anchors to meet any wall construction
- Any width and height
- Any jamb depth
- Double egress doors available

MATERIAL OPTIONS

- 14-gauge and 12-gauge steel

FEATURE OPTIONS

- Continuous weld
- ● Up to 3 hour fire label

HARDWARE REINFORCEMENTS

- ● Optional prep to accept all manufacturers' hardware requirements

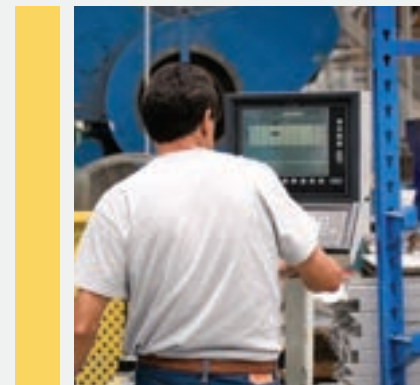

POCKET SLIDER FRAME

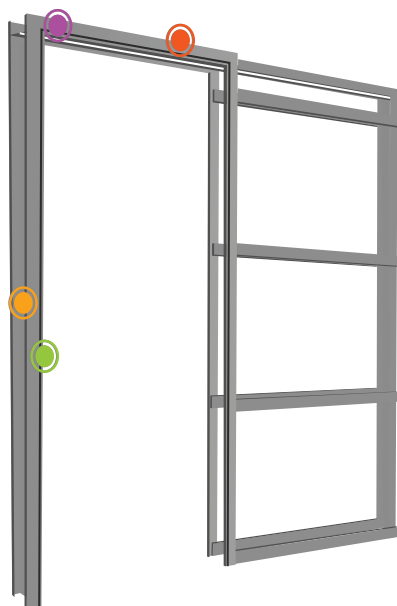

FEATURES

- Face weld
- 16-gauge A40 galvanized steel standard
- Rust-inhibitive prime coat ANSI/SDI 250.10
- Any manufacturer's strike prep location
- Anchors to meet any wall construction
- Any width and height
- Any jamb depth

MATERIAL OPTIONS

- 14-gauge and 12-gauge steel

FEATURE OPTIONS

- Continuous weld

HARDWARE REINFORCEMENTS

- Optional prep to accept all manufacturers' hardware requirements
- Sliding track and hardware not provided



MASONRY FRAMES

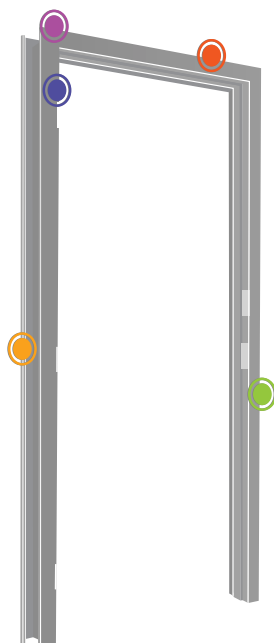

FEATURES

- Face weld
- 16-gauge A40 galvanized steel standard
- 7-gauge hinge reinforcements standard
- 12-gauge closer reinforcements standard
- Rust-inhibitive prime coat ANSI/SDI 250.10
- Any manufacturer's hinge locations
- Any manufacturer's strike prep location
- Anchors to meet any wall construction
- Any width and height
- Any jamb depth

MATERIAL OPTIONS

- 14-gauge and 12-gauge steel

FEATURE OPTIONS

- Continuous weld

HARDWARE REINFORCEMENTS

- Optional prep to accept all manufacturers' hardware requirements



SOUND TRANSMISSION CONTROL (STC) FRAMES

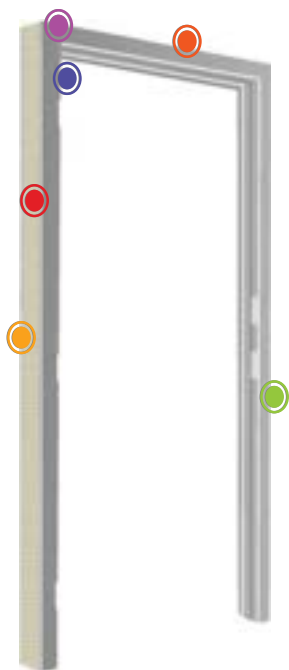

FEATURES

- Face weld
- 16-gauge A40 galvanized steel standard
- 7-gauge hinge reinforcements standard
- 12-gauge closer reinforcements standard
- Rust-inhibitive prime coat ANSI/SDI 250.10
- Any manufacturer's hinge locations
- Any manufacturer's strike prep location
- Anchors to meet any wall construction
- Any width and height
- Any jamb depth
- Must be grout filled (by others)
- STC doors available

MATERIAL OPTIONS

- 14-gauge and 12-gauge steel

FEATURE OPTIONS

- Continuous weld
- Up to 90 minute fire label

HARDWARE REINFORCEMENTS

- Optional prep to accept all manufacturers' hardware requirements

STC Transmission Class Capabilities

STC Range	Description
STC 50 - STC 54	Very loud sounds are faintly heard
STC 40 - STC 49	Loud speech is barely audible
STC 35 - STC 39	Loud speech is audible but words hard to distinguish
STC 30 - STC 34	Loud speech can be distinguished; normal speech barely heard or inaudible

WINDOW FRAMES

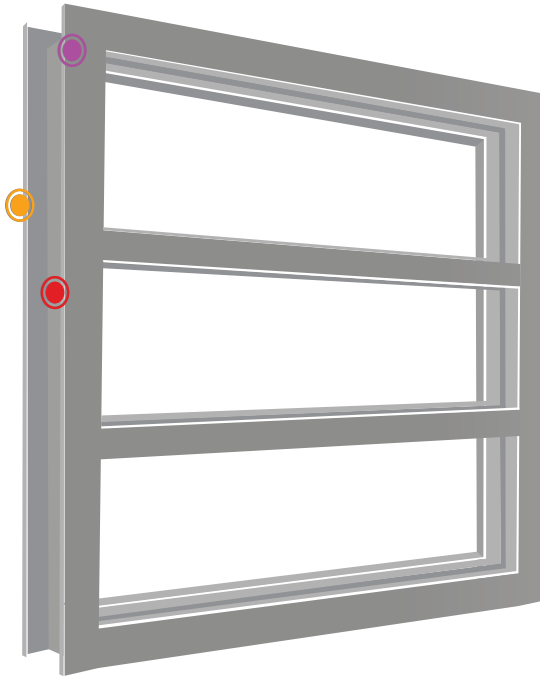

FEATURES

- Face weld
- 16-gauge A40 galvanized steel standard
- Rust-inhibitive prime coat ANSI/SDI 250.10
- Anchors to meet any wall construction
- Any width and height
- Any jamb depth
- Available in KD Drywall or Masonry
- Glass stop $\frac{5}{8}$ " width standard. Custom sizes available
- Glazing not included

MATERIAL OPTIONS

- 14-gauge and 12-gauge steel

FEATURE OPTIONS

- Up to 90 minute fire label
- Continuous weld
- Up to STC 53; fire rated up to STC 37



DCI Hollow Metal appreciates the relationship we have with our dealers. Our goal is to lead the industry in providing clear, up-to-date information that helps you support your customers. Consult the Library section of the DCI Hollow Metal website for the latest in order sheets, product feature sheets, forms, and more.

SAMPLE PRODUCT SHEETS

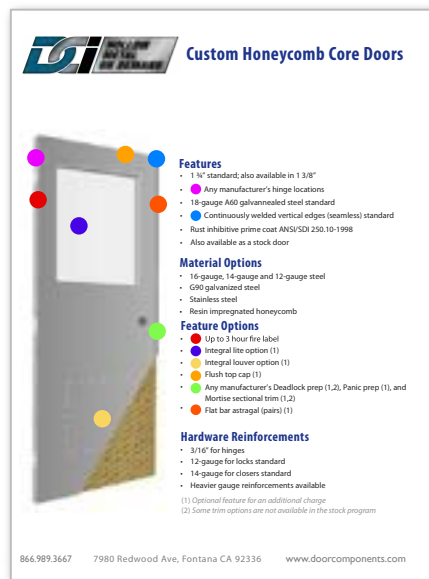

SAMPLE ORDER SHEETS

[illegible]

SAMPLES FROM TECHNICAL DATA MANUAL

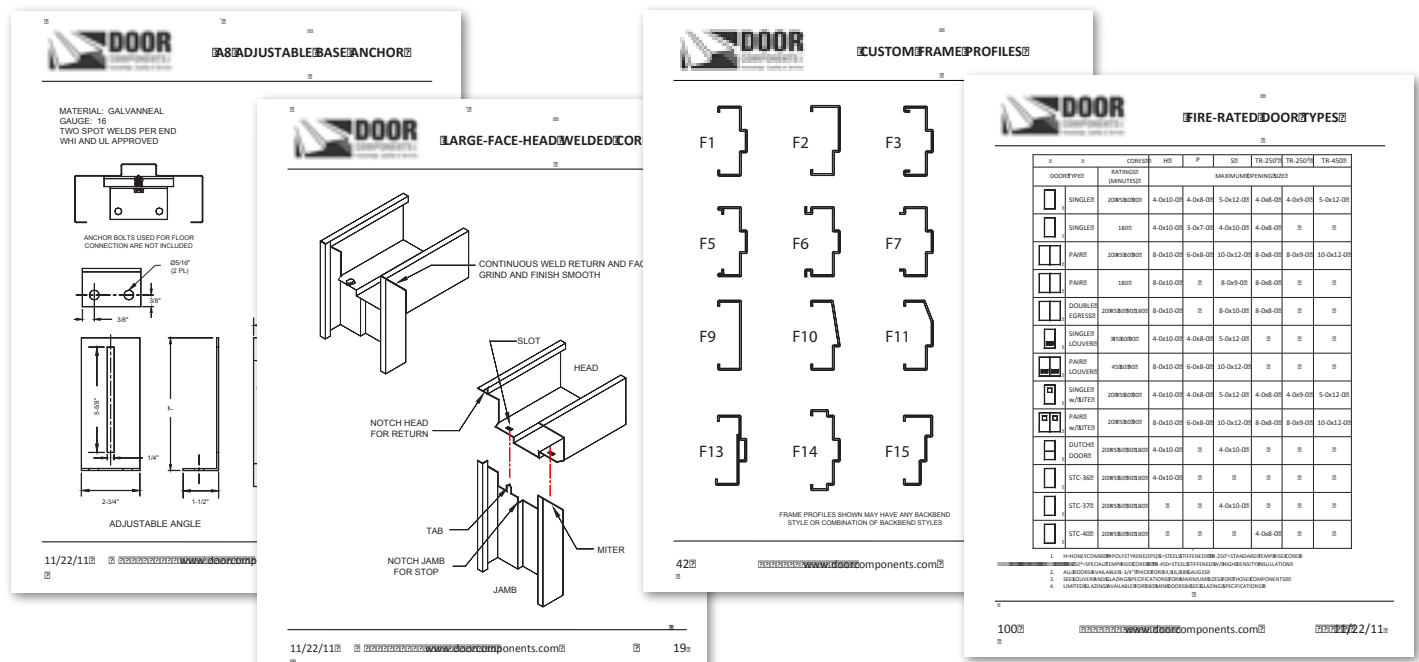



Standards As Tough As Steel.™

**Door Components Inc.
7980 Redwood Ave.
Fontana, CA 92336**

**Toll Free 866.989.9667
Local Phone 909.770.5700
Fax 909.770.5722**

DCIHOLLOWMETAL.COM

