

A1 STANDARD STRAP ANCHOR

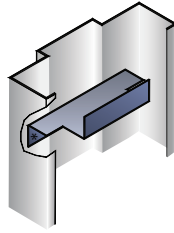

A2 FLUSH METAL STUD ANCHOR

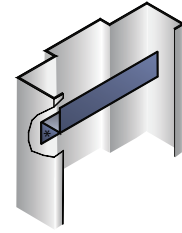

A3 RECESSED METAL STUD ANCHOR

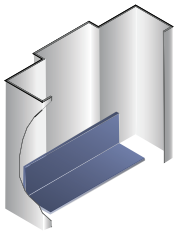

A4 STANDARD BASE ANCHOR

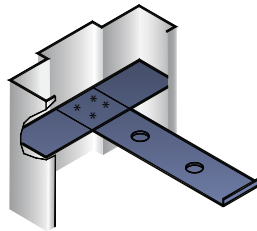

A5 MASONRY STEEL ANCHOR

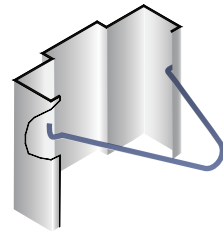

A6 ALTERNATE MASONRY STEEL ANCHOR

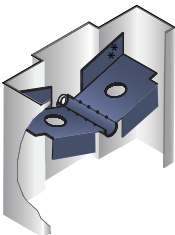

A7B PUNCH & DIMPLE  
"BUTTERFLY" ANCHOR

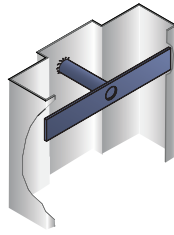

A7P PUNCH & DIMPLE  
ALTERNATE MASONRY ANCHOR

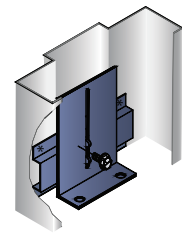

A8 ADJUSTABLE BASE ANCHOR 5/32

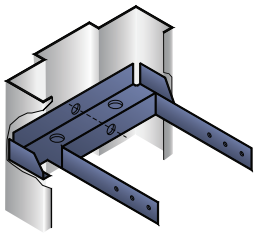

A9T TWISTED UNIVERSAL ANCHOR

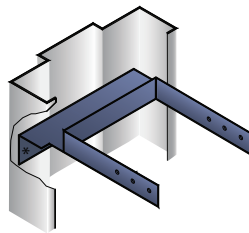

A9W WELDED UNIVERSAL ANCHOR

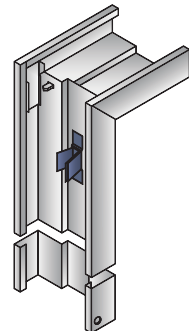

A10 KDDW COMPRESSION ANCHOR

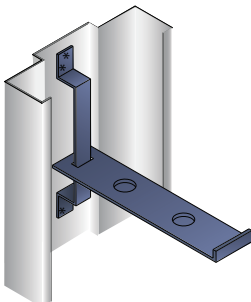

A11 ADJUSTABLE MASONRY ANCHOR

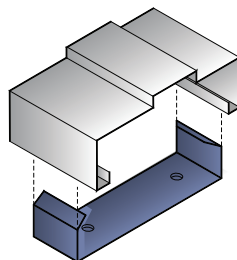

A12 FLOOR ANCHOR ANCHOR