

PS-100 POCKET DOOR FRAME

NOTES:

- 1.) TRACK POCKET DESIGNED TO ACCEPT GRANT 1230 / HAGER 9110 ASSEMBLIES (BY OTHERS)
- 2.) POCKET SLIDER FOR 1-3/4" DOOR
- 3.) SINGLE ELEVATION SHOWN (PAIR SIMILAR)
- 4.) MATERIAL: 16GA A60 GALVANNEAL
- 5.) SPECIFY STEEL STUD OR WOOD STUD ANCHORS

VIEW FROM EXTERIOR SIDE

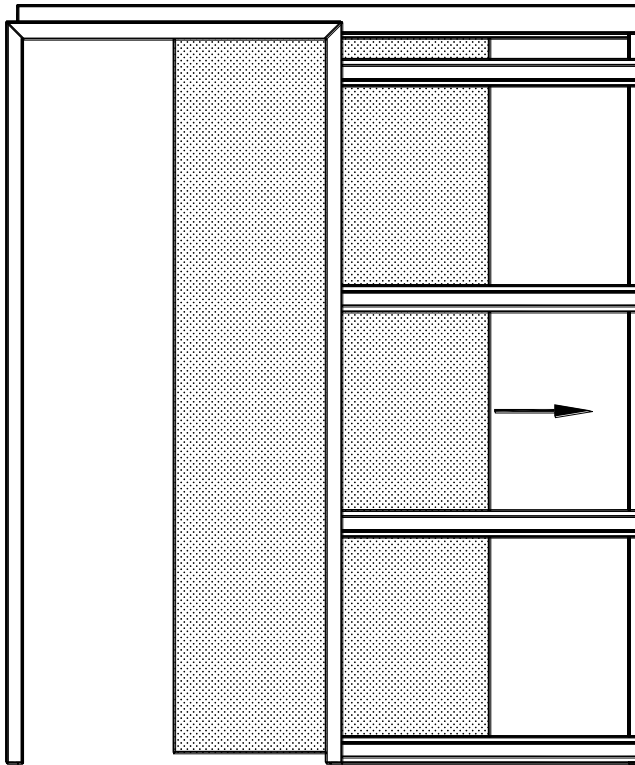

VIEW FROM INTERIOR SIDE

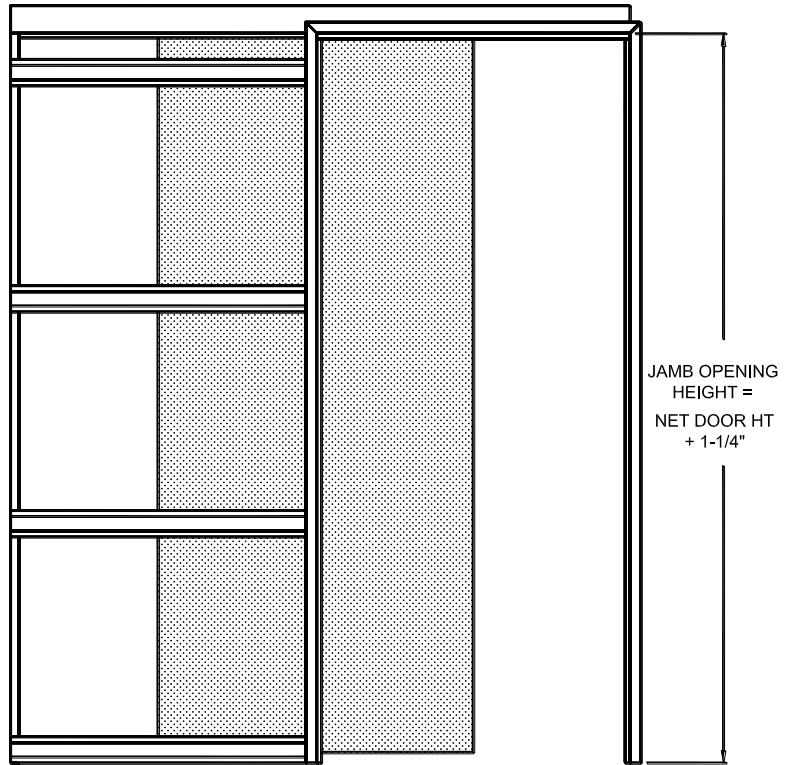

HANDING:
RIGHT HAND SHOWN
(OPENS TO THE **RIGHT** WHEN VIEWED FROM **EXTERIOR**)

HANDING:
RIGHT HAND SHOWN
(OPENS TO THE **LEFT** WHEN VIEWED FROM **INTERIOR**)

